

## Honeymead, Welwyn, Hertfordshire, AL6

 2 Bedrooms

 2 Bath/Shower Rooms

 1 Reception Room

 Garage & Off Street  
Parking for 3 Cars

 Private Garden

 EPC Band D

Council Tax  
Band: E – £2,898.23 (2025-2026)

Guide Price  
£475,000 Freehold

 **ashtons**  
for life's great moves

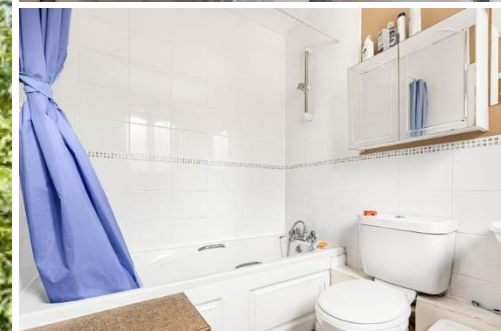



This two bedroom home is ideally located for Welwyn North Station and offers well balanced accommodation over three floors. The property is offered chain free.

## Description

Nestled in a peaceful cul de sac in the heart of Digswell, this charming two bedroom townhouse offers the ideal blend of space, style, and convenience. Digswell boasts a village feel with excellent commuter links via Welwyn North station — just a short stroll from your doorstep. Step into the spacious ground floor, where a generous living room at the front features a sizeable window allowing plenty of natural light. To the rear, the kitchen benefits from ample storage, leading into a versatile extended conservatory. A handy guest W/C completes this level.

Ascend to the first floor to find a large double bedroom with built in wardrobe space, accompanied by a spacious family bathroom featuring a white three piece suite.

The second-floor hosts another inviting double bedroom, featuring further built in storage options. Outside, a hard standing driveway provides off street parking for three cars, while the adjoining garage which can be accessed from the garden as well, offers an additional parking space or practical storage solution. The low maintenance rear garden is ideal for easy care and outdoor leisure. Being sold with no onward chain.

## Location

Honeymead is located in the sought after village of Digswell. The village offers an array of shops, a pub and a renowned primary school. Welwyn North Station is a couple of minutes' walk away. Extensive shopping and leisure facilities can be found close by in Welwyn Garden City just three miles away.

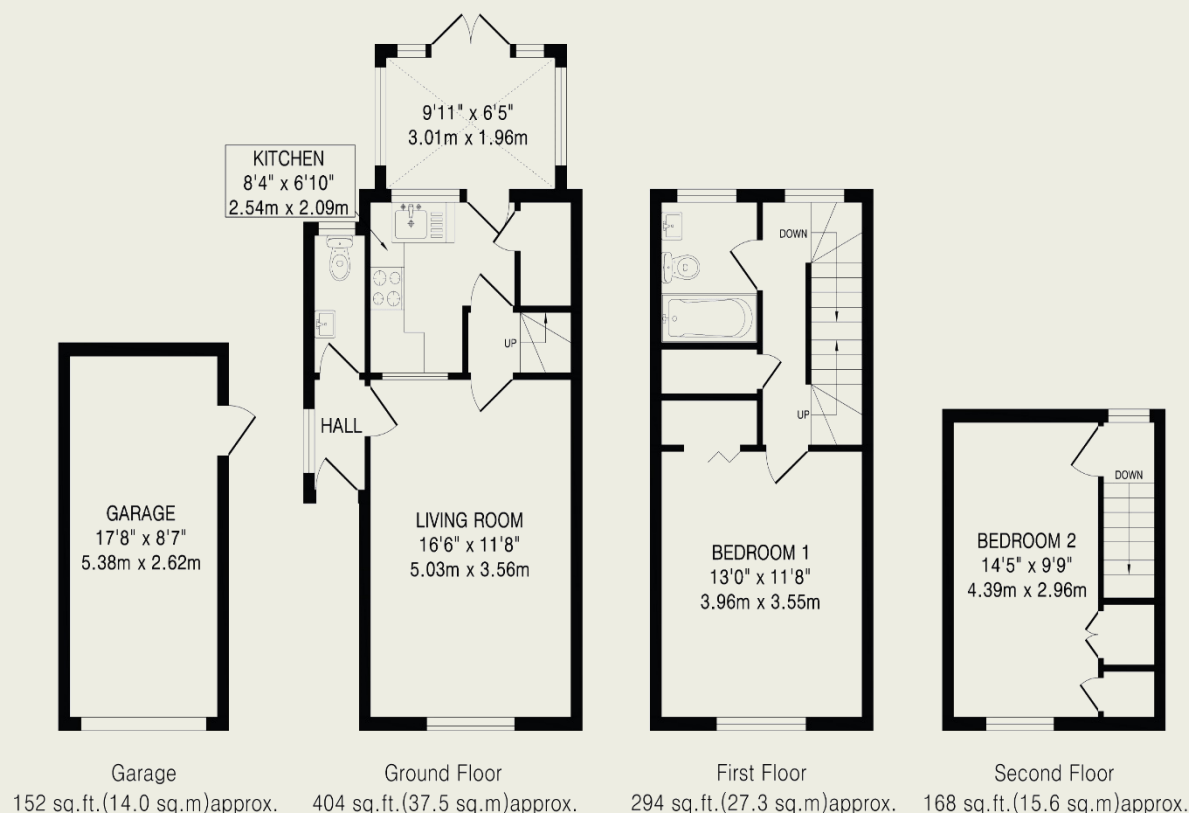

TOTAL FLOOR AREA: 866 sq.ft. (80.4 sq.m) approx.

This floorplan is for illustration purposes only. The measurements and position of each element are approximate and must be viewed as such.

### Important Information

These particulars do not constitute an offer or contract in whole or part. The statements contained herein are made without responsibility on the part of Ashtons or the vendors and they cannot be relied upon as representatives of fact. In respect of floor plans, these are for illustrative purposes only. The measurement and position of each element is approximate and must be viewed as such. Intending purchasers should therefore satisfy themselves by inspection or otherwise as to their correctness. The vendors do not make or give, and neither Ashtons nor any person in their employment has any authority to make or give, any representation or warranty whatsoever in relation to this property.

We offer a wide range of services through third-party providers including solicitors, surveyors, removal firms, mortgage providers and EPC suppliers. We receive additional payments for administering suppliers quoting software and making referrals. You are not under any obligation to use these services and it is your discretion whether you choose to deal with these parties or your own preferred supplier. You should be aware the average payment we received in 2021 equated to £48.36 per referral.