



3 Bedrooms



1 Shower Room + WC



2 Reception Rooms



Garage & Driveway



Courtyard Garden & use of  
Communal Gardens



EPC Band TBC

Council Tax

Band E: £2,883.39 2025/26

Local Authority  
St Albans Council

Service Charge Communal  
Grounds: £200 pa



The Park, Redbourn, AL3  
Guide Price £525,000 Freehold



## The Park, Redbourn, AL3

Sought after three bedroom village home, close to High Street amenities and Redbourn Common.

- 🏡 Spacious three-bedroom home
- 🏡 Sought after location
- 🏡 Close to High Street and Common
- 🏡 Living room, dining room and conservatory
- 🏡 Modern kitchen
- 🏡 Upstairs shower room
- 🏡 Low-maintenance courtyard garden & pretty communal Gardens

### Description

This excellent semi-detached home offers spacious accommodation and is located in The Park, a popular development which has attractive communal gardens for the use of the residents.

The accommodation includes an entrance hall, guest cloakroom and large living room which leads into a pretty conservatory at the rear. There is a separate dining room which opens into a fitted kitchen with a good range of units, built-in eye-level oven, gas hob, space for a fridge freezer and plumbing for a washing machine.

Upstairs there are three bedrooms, two doubles and a single which are served by a modern shower room.

Outside the courtyard garden is paved for low-maintenance, steps lead up to a useful brick built storage shed. The property backs onto communal gardens and a gate at the rear gives access out to the gardens - a wonderful benefit of living in The Park!

### Location

Located in The Park, a sought after area close to the High Street and Common in Redbourn, a picturesque village in Hertfordshire. Conveniently located for the M1, J9 and M25 motorways and Luton Airport, with easy access to efficient rail links at Harpenden and St.Albans.







**Important Information**

These particulars do not constitute an offer or contract in whole or part. The statements contained herein are made without responsibility on the part of Ashtons or the vendors and they cannot be relied upon as representatives of fact. In respect of floor plans, these are for illustrative purposes only. The measurement and position of each element is approximate and must be viewed as such. Intending purchasers should therefore satisfy themselves by inspection or otherwise as to their correctness. The vendors do not make or give, and neither Ashtons nor any person in their employment has any authority to make or give, any representation or warranty whatsoever in relation to this property. We offer a wide range of services through third party providers including solicitors, surveyors, removal firms, mortgage providers and EPC suppliers. We receive additional payments for administering suppliers quoting software and making referrals. You are not under any obligations to use these services and it is your discretion whether you choose to deal with these parties or your own preferred supplier. You should be aware the average payment we received in 2021 equated to £48.36 per referral.

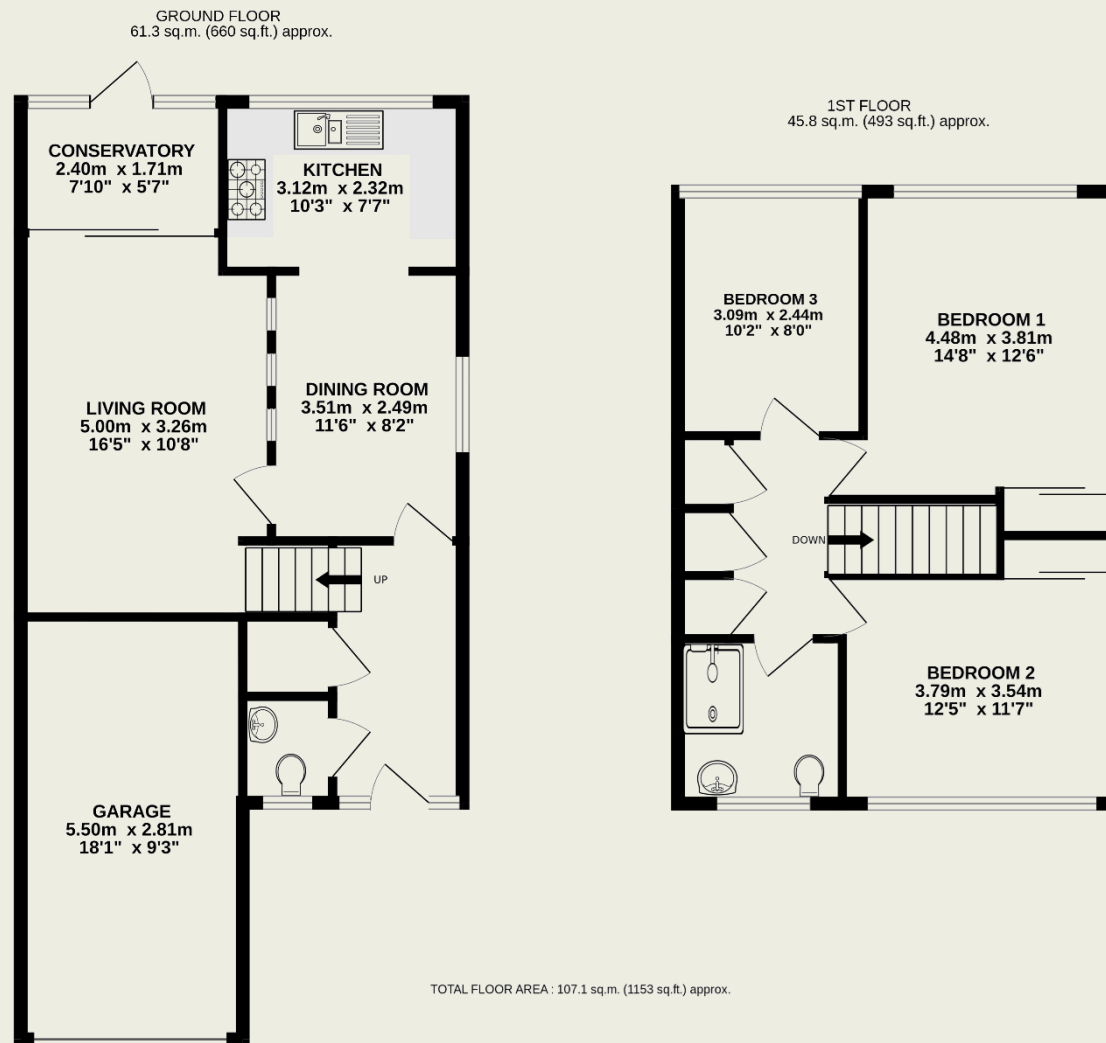

This floorplan is for illustrative purposes only. The measurement and position of each element is approximate and must be viewed as such.