



3 Bedrooms



2 Bath/Shower Room



2 Reception Rooms



Garage



Private Garden



EPC Band D

Council Tax

Band E: £2,800.97 2025/26

Local Authority

Welwyn Hatfield Council



**Digswell Rise, Welwyn Garden City, Hertfordshire, AL8**  
**Guide Price £600,000 Freehold**



## Digswell Rise, Welwyn Garden City

A modern style detached property with a conservatory and South facing garden situated in this prime West Side cul-de-sac, a short stroll from the town centre.

🏡 3 Bedroom Detached Home

🏡 Fantastic Location on West Side

🏡 2 Reception Rooms

🏡 2 Bathrooms

🏡 South Facing Garden

🏡 Garage and Driveway

🏡 Renowned Schooling Close By

### Description

This well-presented three bedroom detached property is offered for sale chain free and provides a great opportunity to purchase a home within a short walk of all the town centre's amenities and mainline station. On the ground floor, the living room has a feature fireplace and opens into the dining room which, in turn, has French doors into a sunny aspect conservatory. There is a fitted kitchen and a single garage, which many local residents have converted to further reception space.

On the first floor, there are three bedrooms and a family bathroom. There is also the additional benefit of built-in wardrobes to the principal bedroom and an en-suite shower room to bedroom two. The exterior features parking for two/three cars to the front and a secluded Southerly aspect 50ft rear garden with a storage shed, lawn area and a raised deck beside the conservatory. Modern comforts include gas fired central heating to radiators and upvc double glazed windows and doors.

### Location

Digswell Rise is in a prime, highly regarded turning in the heart of the popular West Side. The town centre's amenities, including John Lewis, the Howard Shopping Centre and mainline rail services to Kings Cross, are all a short walk away and the renowned Templewood primary school is also close by.







**Important Information**

These particulars do not constitute an offer or contract in whole or part. The statements contained herein are made without responsibility on the part of Ashtons or the vendors and they cannot be relied upon as representatives of fact. In respect of floor plans, these are for illustrative purposes only. The measurement and position of each element is approximate and must be viewed as such. Intending purchasers should therefore satisfy themselves by inspection or otherwise as to their correctness. The vendors do not make or give, and neither Ashtons nor any person in their employment has any authority to make or give, any representation or warranty whatsoever in relation to this property. We offer a wide range of services through third party providers including solicitors, surveyors, removal firms, mortgage providers and EPC suppliers. We receive additional payments for administering suppliers quoting software and making referrals. You are not under any obligations to use these services and it is your discretion whether you choose to deal with these parties or your own preferred supplier. You should be aware the average payment we received in 2021 equated to £48.36 per referral.



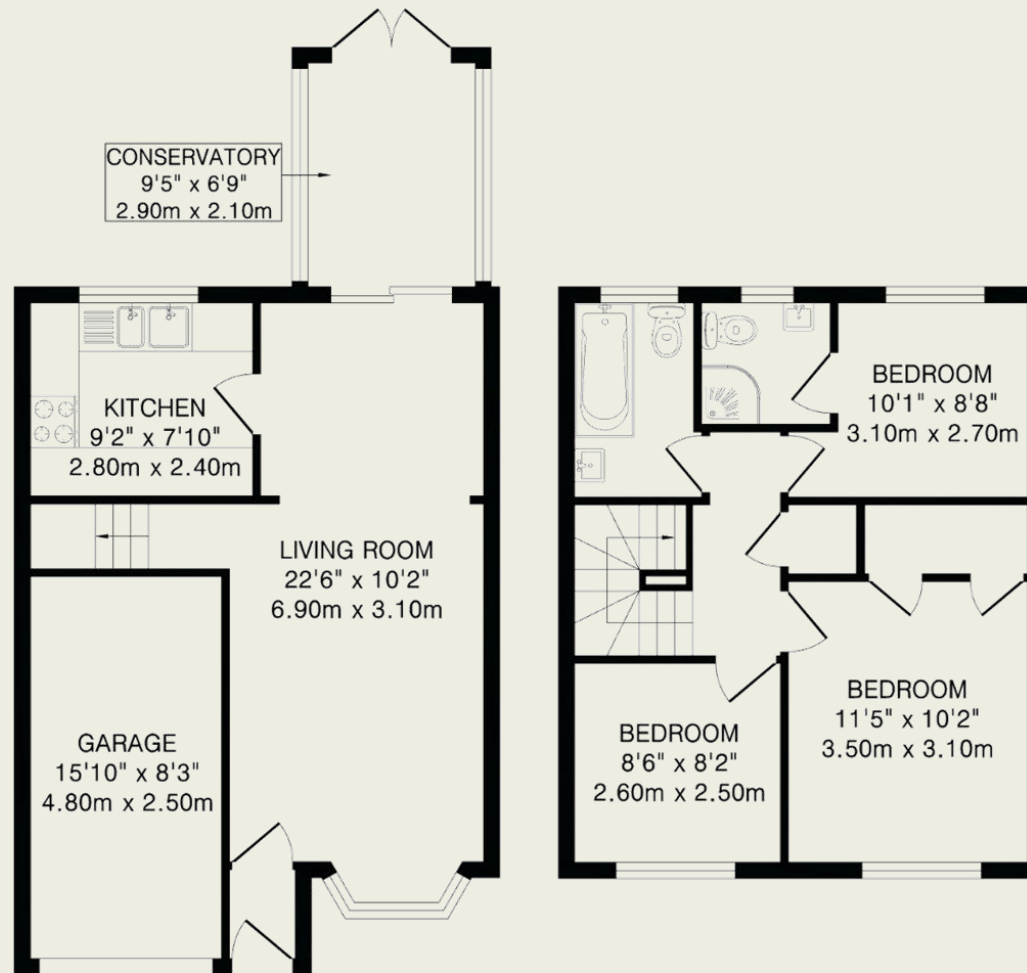

Ground Floor  
528 sq.ft.(49.1 sq.m)approx.

First Floor  
414 sq.ft.(38.5 sq.m)approx.

TOTAL FLOOR AREA: 942 sq.ft.(87.6 sq.m)approx.

This floorplan is for illustrative purposes only. The measurement and position of each element is approximate and must be viewed as such.